

1200SS Floor Drain w/ Fixed Top

Regularly Furnished: 304 stainless steel round industrial floor drain with loose set medium duty slotted grate, seepage openings and bottom outlet.

Catalog No.	Grate Free Area (Sq.In.)	•
1200SS-85	13.5	

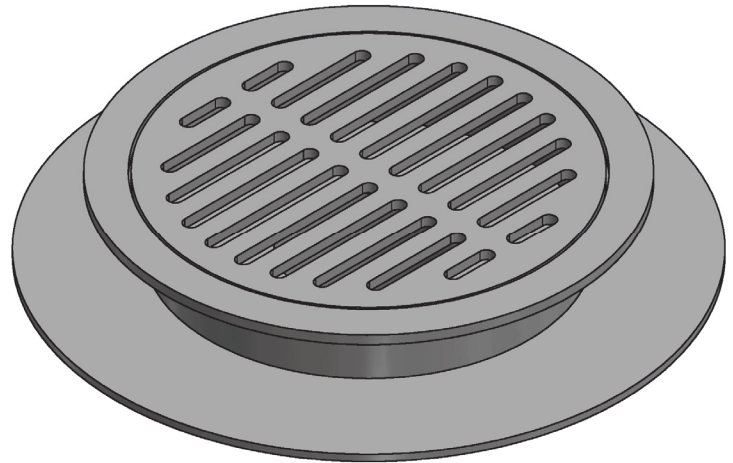

Project	
Engineer	
Mechanical	

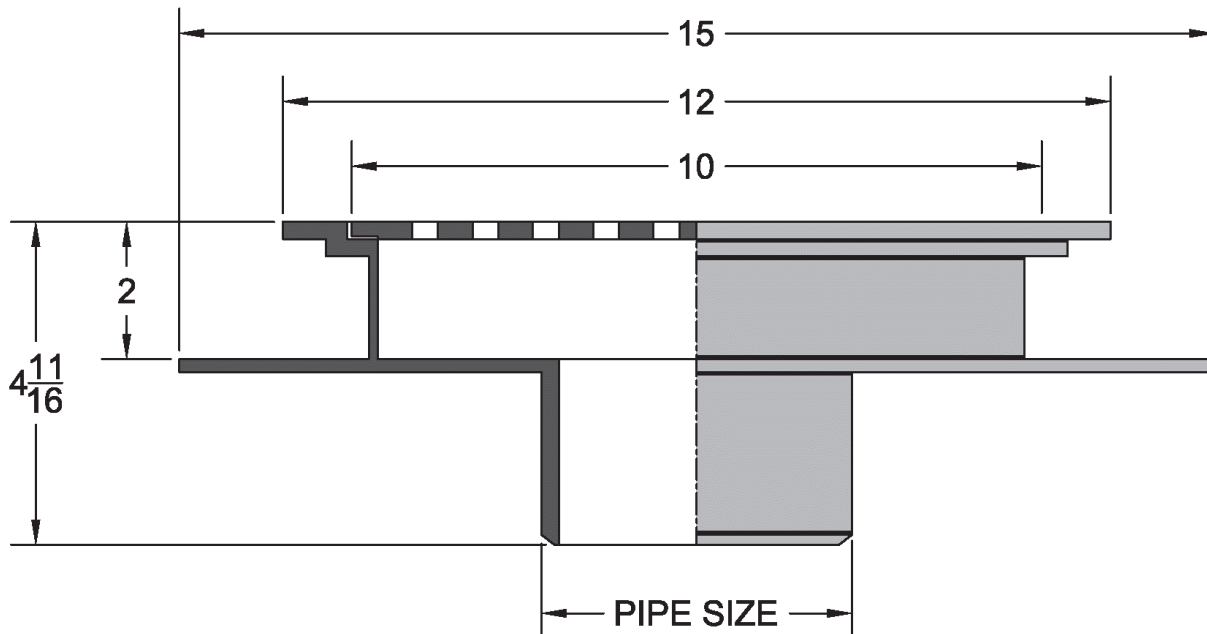

Outlet Options		
Suffix	Description	•
-BW	Butt-Weld Sch.10 (2BW, 3BW, 4BW, 6BW)	
-NH	No-Hub (2NH, 3NH, 4NH, 6NH)	

Grate Options		
Suffix	Description	•
-153	Heavy Duty Reinforced Grate	

Funnel Options		
Suffix	Description	•
-EF4	4" Diameter Funnel (4" High)	
-EF6	6" Diameter Funnel (4" High)	
-EG8	3-1/2 x 8-1/4 Elongated Funnel (3-1/2" High)	

Suffix Options		
Suffix	Description	•
-SA	Stabilizer Anchor Clips	
-TSD	Trap Seal Device	
-VP	Vandal Proof (Secured Grate)	
-6	1/2" NPT Trap Primer Connection	
-26	Membrane Clamp Device	
-27	Sediment Basket	
-31	Backwater Valve (Brass Trim)	
-316	316 Stainless Steel	